



AHead Simulations

Mounting Instructions



Mounting of CARL will depend on your lab/classroom setup. Below are some suggested mounting orientations.

1. Place directly on the table/test box.

This may not be preferred for some classroom set-ups as it takes up desk space. As shown below, for use with verification equipment, it can sit on top of the test box to orient itself to the speakers (with a Verifit1). There are silicone pads on the bottom of CARL to ensure slipping will not occur, and no marking of the desk.



Note: While pictures show the use of a Verifit, CARL is compatible with all equipment, and can be used to compare different equipment. Shoulders on CARL are meant for usage with Otometrics Freefit.

2. Suction Cup Feet

Suction Cup feet can also be used with CARL to provide stability and reduce potential of damage (available from AHead Simulations as an add-on to your order).

Although CARL is now being manufactured with specialized taps specifically for these suction cups on the outer corners of the base, these suction cups are still compatible with the VESA standard taps mentioned before (will not be threaded all the way into the taps but still provides sufficient security).

For CARL with only the VESA standard taps:

Take the suction cup feet and twist them into the taps until you feel resistance. Note that the suction cups will not twist all the way into these taps. Once all four suction cups are placed into the taps, place CARL on a flat surface and push down. Your CARL should now be ready for use.

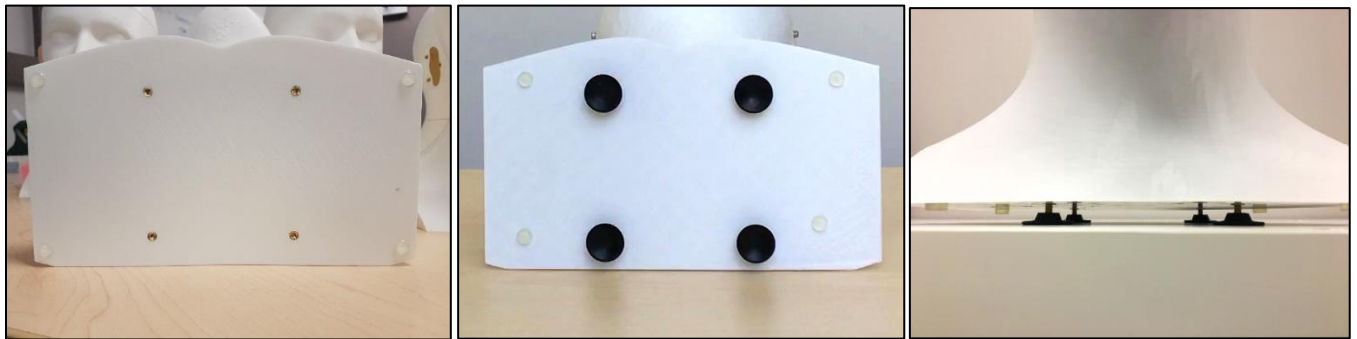

For CARL with both the VESA standard taps and the specialized suction cup taps:

Take the suction cup feet and twist them into the outermost taps. Note that the suction cups will twist all the way into these taps. Once all four suction cups are placed into the taps, place CARL on a flat surface and push down. Your CARL should now be ready for use.

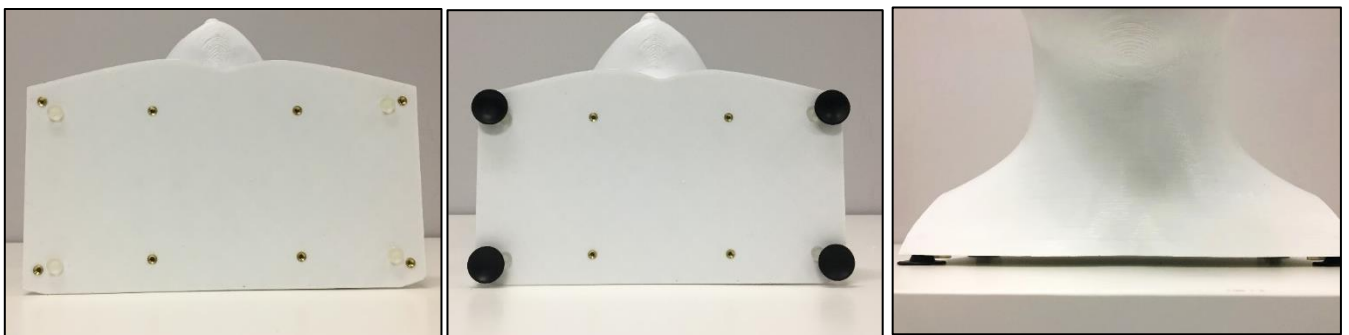

3. Mounting Bracket

CARL has a standard VESA mount that can be used with any standard monitor arm. The screws that come with the mount will have the ability to bolt into the bottom of CARL without the need to tighten bolts on the inside of the head.

Specs: CARL uses the 100mm x 100mm VESA standard. Mounting hardware should be included with the purchased mount.



To be compatible with CARL, ensure that the mounting platform included with the mount you decide to purchase is capable of rotating 180 degrees to be parallel with the ground. This system can allow for raising of the height and orientation of CARL while not taking up any desk space.

Note: The CARL pictured below does not have the USB connection to use the software. If use of the software is desired with the mounting option, the USB cable can be routed along the monitor arm with the connection to a computer beside the equipment.

The following are suggested full-motion mounts to use with CARL:

North Bayou Monitor Desk Mount Stand Full Motion Swivel Monitor Arm Gas Spring

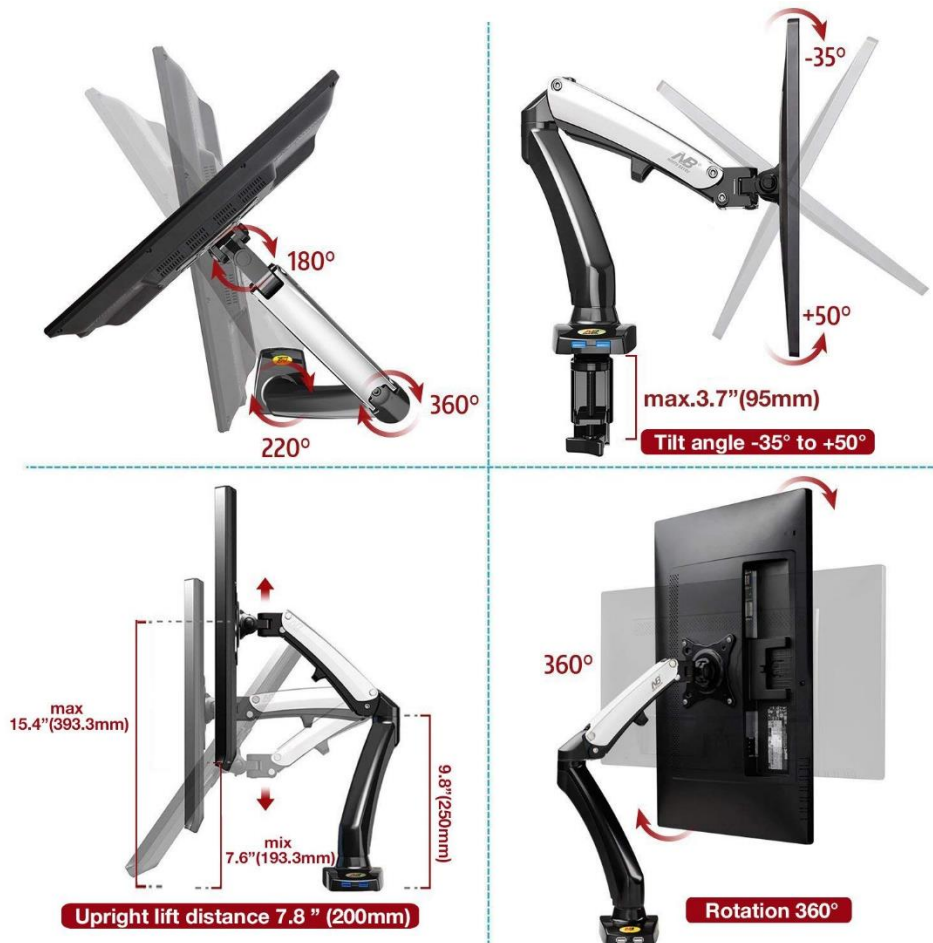

Mount-It! Height Adjustable Full Motion Monitor Stand for VESA 75 and 100, Gas Spring Arm



The use of a monitor arm can allow for CARL to be swiveled in and out of the workspace and allow for custom height adjustment with the equipment you are using. Seen below is CARL being positioned for a Verifit using an example of a modified mount within a lab environment.

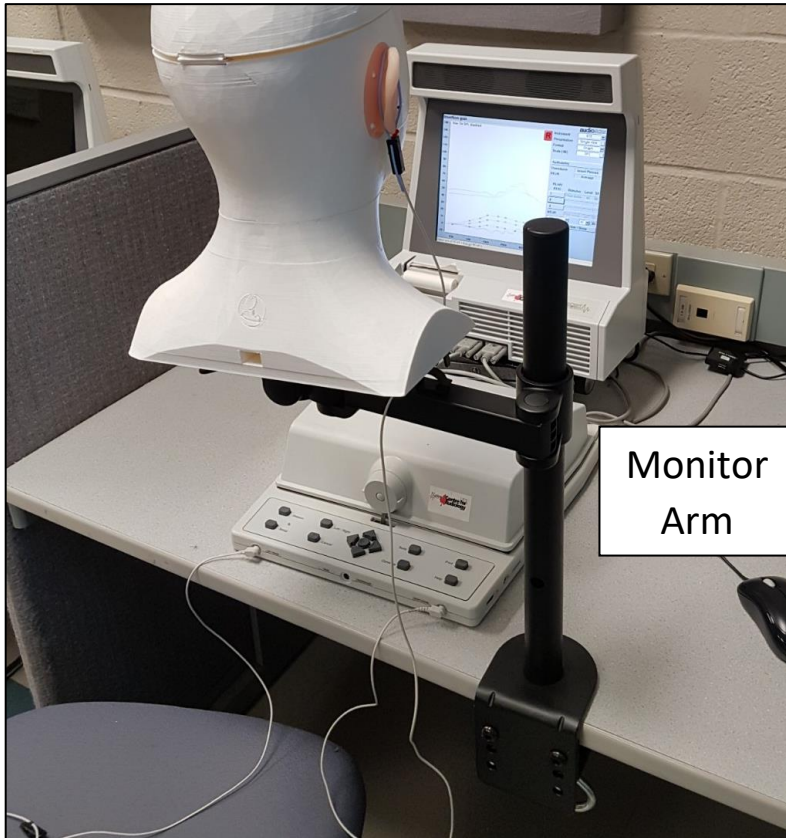

Using a different mounting set-up? Let us know and give us your feedback! Pictures or recommendations are encouraged and can be sent to feedback@aheadsimulations.com.